

**ARTICULATED HEAD PLATE KA41**

UNE-EN 61537  
REV.14/06/2017

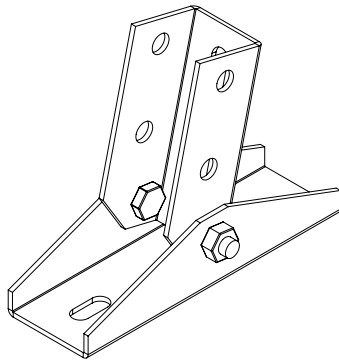

**ARTICULATED HEAD PLATE KA41**



Coating: HDG, SS304, SS316

Characteristics:

- Metallic
- Non-flame propagating component
- Electrically conductive component
- With metallic coating. Resistance to corrosion:

HDG: class 6      SS304: class 9A      SS316: class 9B

**INSTRUCTIONS FOR USE**

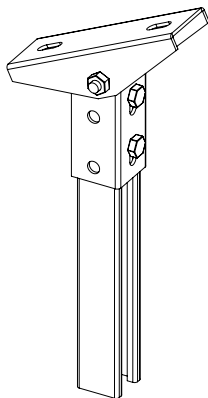

- Articulated head plate KA41 is used to fix 41x41 strut profiles to slanted walls, floor or ceiling.
- To fix KA41 to wall two anchors SCM 12x85 are needed.
- To fix 41x41 strut profile to KA41, two spring nuts M10 and two bolts M10x30 DIN 933 are needed.
- To fix KA41 in the slotted face of the strut profiles 2 B3 M10x20 bolt sets are needed.
- KA41 is usually used with products of BASORPERFIL 41/82 family to make up rack supports, special tunnel supports, or even solar energy structures.

**WORKING LOAD INFORMATION**

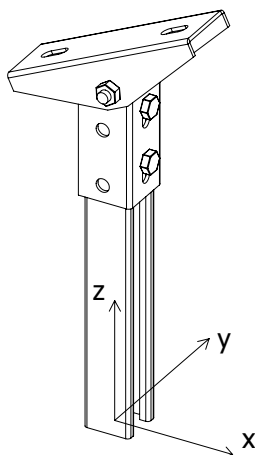

ADMISSIBLE EFFORTS	
KA41	Fz
	kg
1200	

Declared values include 1.7 safety factor as requested in EN IEC 61537 for cable tray supports.

Related products:

BASORPERFIL 41/82 profiles and accessories.